



# KITZMILLER WETLAND PARK VISION

OCTOBER 2021

# ACTIVE DESTINATION PARK

*This plan depicts proposed improvements for the Kitzmiller Wetland Park. These schematic designs are conceptual and provide a vision of how the park could be developed to meet the goals and recommendations found in the 2021 Parks Framework Plan.*

The Kitzmiller Park is currently categorized as a parkland preserve and destination park in the Parks Framework Plan. Surveys completed for the development of the Parks Framework Plan identified a community desire for more active recreational equipment; accordingly, this vision demonstrates that the preservation and access to natural resources via trails and boardwalks can coexist on a site with robust active recreational activities. Wetlands, mature tree stands, and prairies currently cover a majority of the site. These great natural assets will be preserved while the upland portion is utilized to consolidate active hardscape elements like a destination playground, the city’s first skatepark, various sport courts, a pavilion, and parking.

This custom playground will be *the* attraction for school-aged kids. Large-scale custom play equipment, nature play and a gracious sloped lawn with embankment slide will keep children busy all afternoon.

Tweens and teens will enjoy a skatepark that is sized and programmed to accommodate regional visitors at all skate levels. Additionally, and in step with New Albany’s dedication to sustainability, the skatepark will be designed in harmony with its ecological surroundings and with stormwater mitigation strategies and plantings.

Parents will love the trellis shade structure, pavilion/restrooms, and parking in close proximity to the playground, skatepark, and trailheads. Families can find a convenient place to post up in the morning and stay busy until sundown.

Three parcels along Kitzmiller Road were acquired through Clean Ohio. These parcels have restrictions on site usage and development. The declaration of these restrictions for these three parcels specifically state:

- The city, in perpetuity, shall maintain the property as passive parkland or greenspace.
- The property, once converted to passive parkland, shall be open to the public 365 days per year.
- Improvement types and amenities are limited to passive activities.

Based on initial research, the entry drive, parking and pavilion shown in this plan are acceptable improvements within these restricted parcels.



### Legend

- ① Skatepark with stormwater management
- ② Activity lawns
- ③ Custom playgrounds
- ④ Overlooks
- ⑤ Trails
- ⑥ Trellis and Seating
- ⑦ Wetlands
- ⑧ Pavilion
- ⑨ Hybrid Sport Court
- ⑩ Pickleball Courts

OVERALL SITE PLAN: BIRD’S EYE LOOKING NORTHWEST

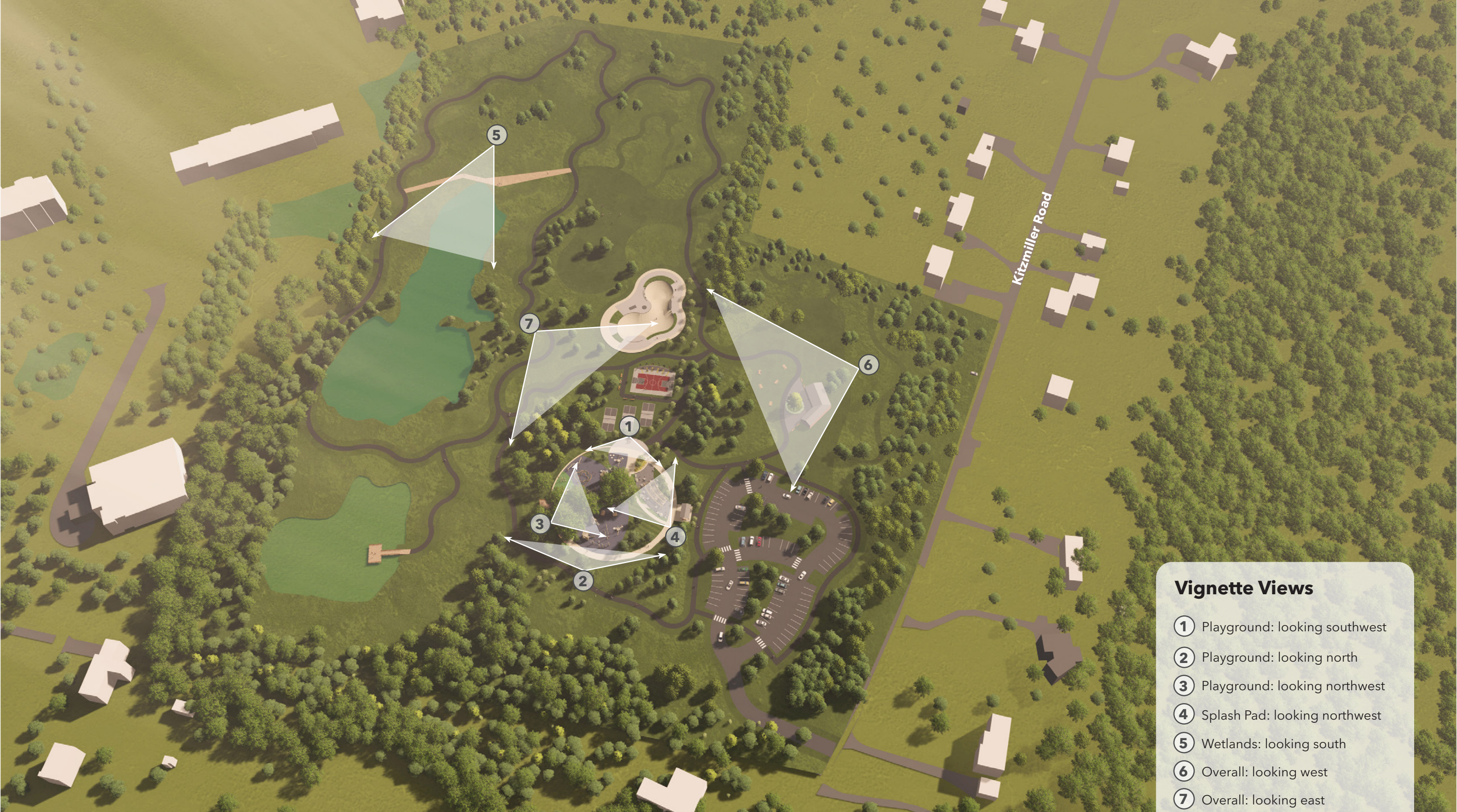

### Vignette Views

- ① Playground: looking southwest
- ② Playground: looking north
- ③ Playground: looking northwest
- ④ Splash Pad: looking northwest
- ⑤ Wetlands: looking south
- ⑥ Overall: looking west
- ⑦ Overall: looking east

## OVERALL SITE PLAN: BIRD'S EYE LOOKING NORTHWEST

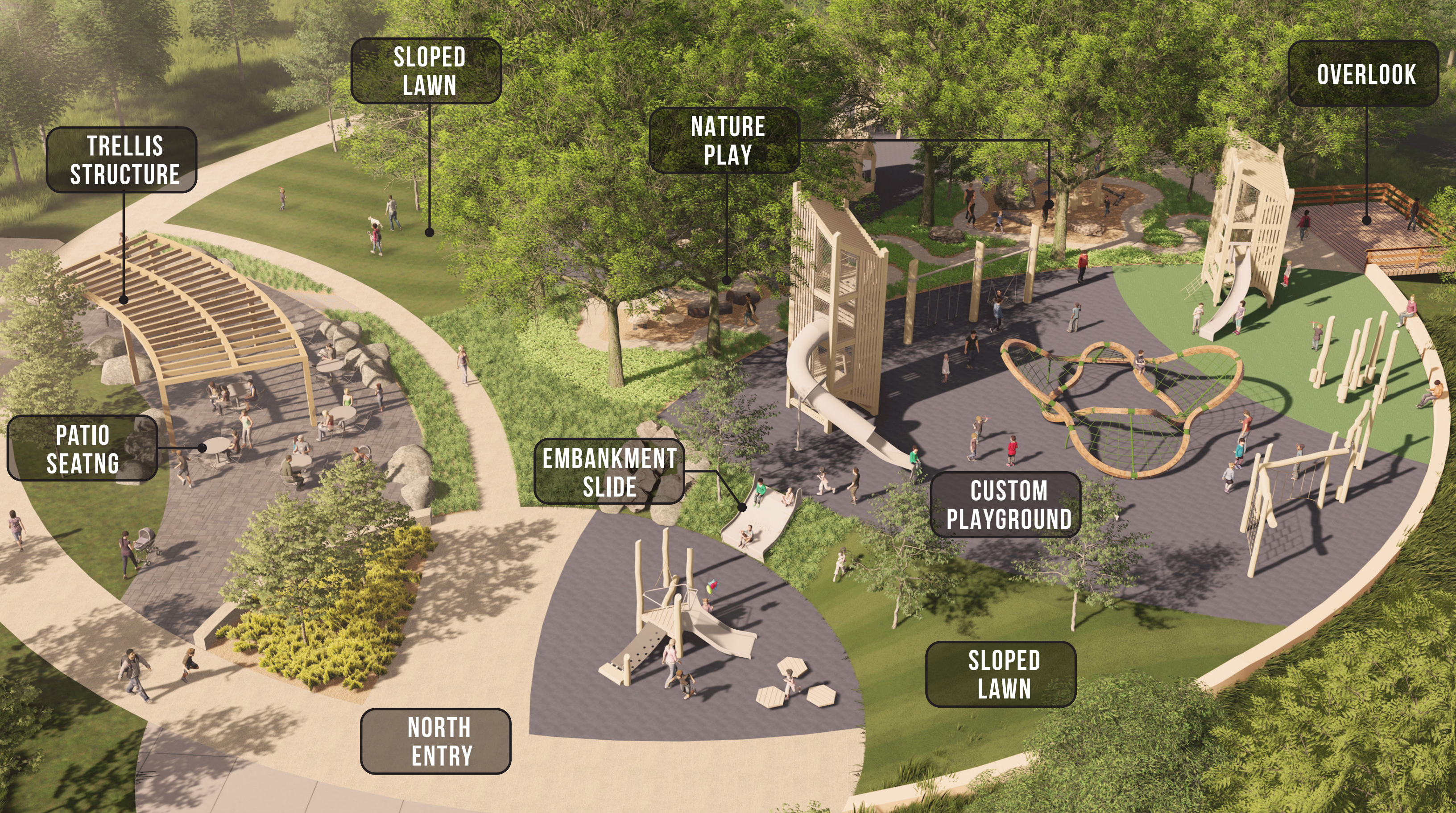

## 1. PLAYGROUND: BIRD'S EYE LOOKING SOUTHEAST

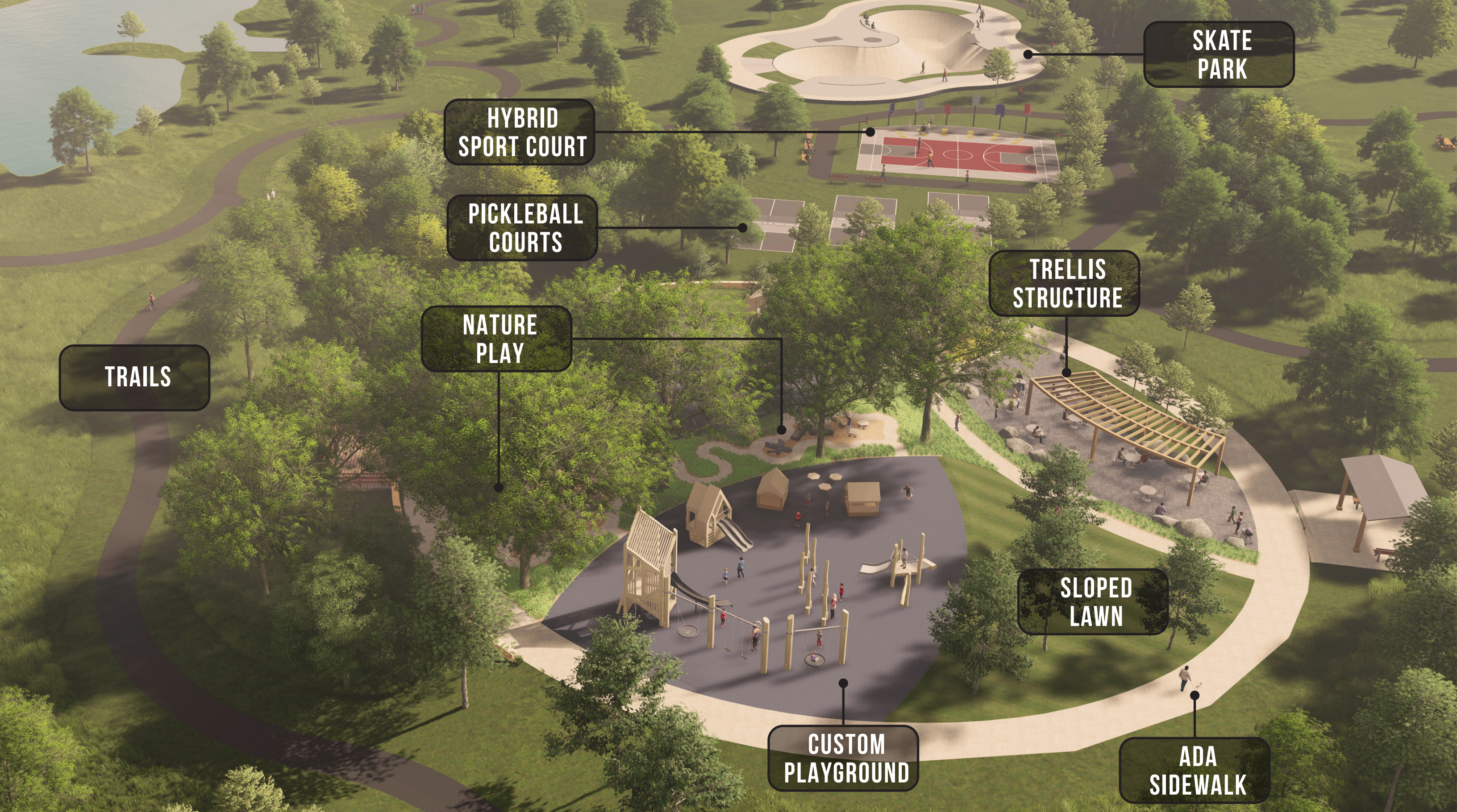

**SKATE  
PARK**

**HYBRID  
SPORT COURT**

**PICKLEBALL  
COURTS**

**TRELLIS  
STRUCTURE**

**NATURE  
PLAY**

**TRAILS**

**SLOPED  
LAWN**

**CUSTOM  
PLAYGROUND**

**ADA  
SIDEWALK**

## 2. PLAYGROUND: BIRD’S EYE LOOKING NORTH



**MULCH  
PATHS**

**NATURE  
PLAY**

**CUSTOM  
PLAYGROUND**

### 3. PLAYGROUND: LOOKING NORTHEAST



**CUSTOM  
PLAYGROUND**

**NORTH  
ENTRY**

**BOULDERS**

**PATIO  
SEATING**

## 4. SPLASH PAD: BIRD'S EYE LOOKING NORTHWEST



**TRAILS**

**WETLANDS**

**WET  
PRAIRIE**

**OVERLOOKS &  
BOARDWALKS**

## 5. WETLAND OVERLOOK, BOARDWALK & TRAILS: LOOKING SOUTH

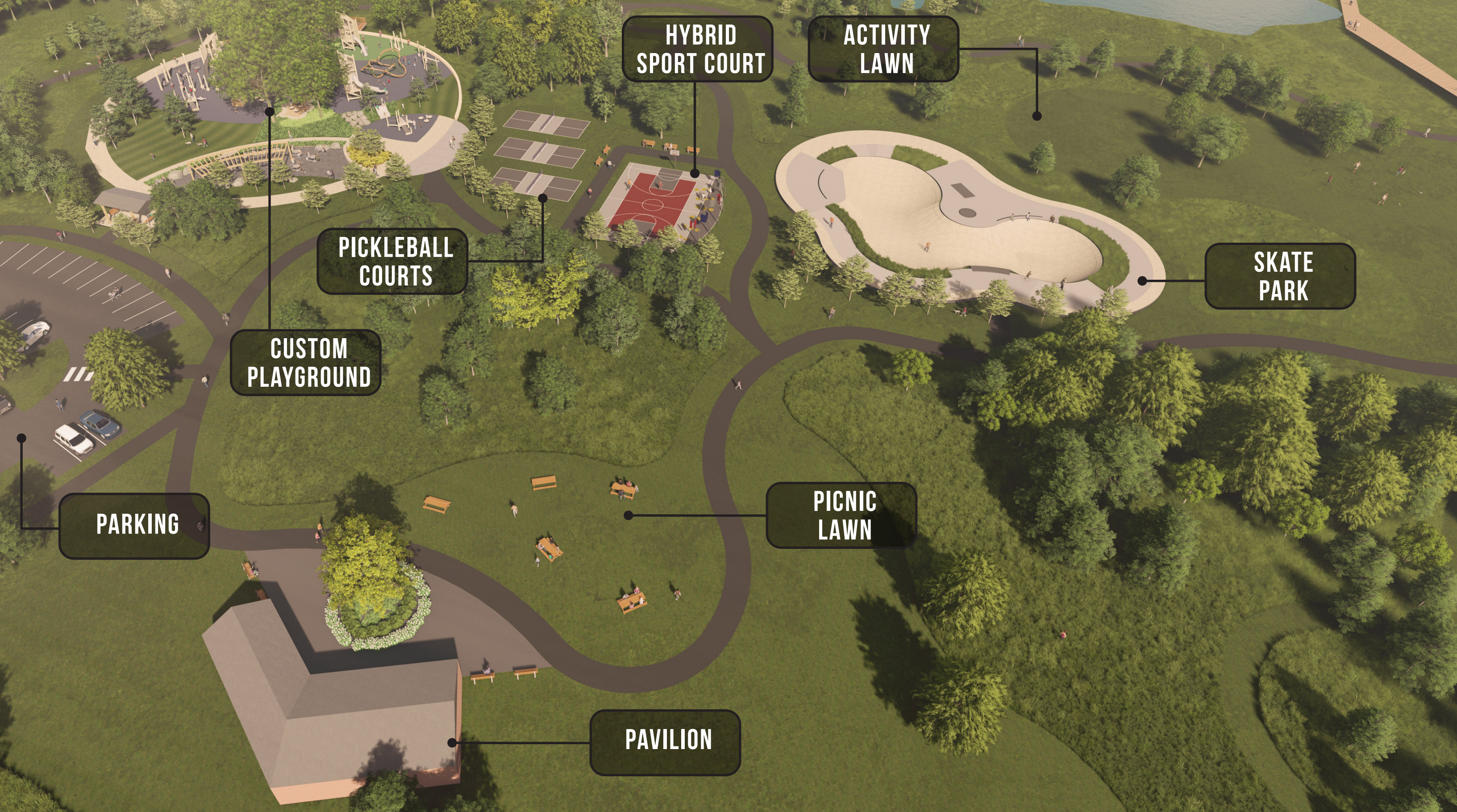

6. BIRD'S EYE LOOKING WEST



**7. BIRD'S EYE LOOKING EAST**

