

# VETERANS MEMORIAL

For the City of New Albany

---

**Prepared for:**

City of New Albany  
**2020 City Council Retreat**

# ACKNOWLEDGEMENTS

Thank you to all the stakeholders and members of the New Albany community who helped shape this plan and its recommendations.

**Working Group**

*The City of New Albany*

Director of Community Development  
Jennifer Chrysler

Director of Administrative Services  
Adrienne Joly

Planning Manager  
Stephen Mayer

Planner  
Chris Christian

*New Albany City Council*

Mayor  
Sloan Spalding

*The Plain Township*

Township Administrator  
Ben Collins

**Focus Group**

Jake Bame

Ron Davies

Paul Hatfield

Sarah Higgiston

Dennis Keesee

Ken Krebs

Rich McMunn

Tom Rubey

Victor Wilson

**Design Team**

*MKSK*

Principal-in-Charge  
Jeffrey Pongonis, PLA, ASLA

Associate, Project Manager  
Karla Salmans, PLA, ASLA

Designer  
McKenzie Wilhelm, ASLA

# CONTENTS

1	Introduction Page 4
2	Making New Albany's Memorial Page 7
3	Location + Program Assessment Page 10
4	Concept Page 24
5	Order of Magnitude Costs Page 44

# 1 INTRODUCTION

## PROJECT PURPOSE

A reimagining of the current New Albany Veterans Memorial has long been considered a desirable opportunity for an improved public amenity. Past efforts to upgrade the Memorial have outlined potential locations and concepts, but were not pushed through to implementation. This project serves as the link between past Veterans Memorial studies to present and future Village Center conditions — befittingly honoring those who have served while adding richness to the existing greenspace network. This final document will illustrate a new Veterans Memorial concept and a chronical of the process leading to the final design.

# TEAM MEMBERS

## CLIENT

CITY OF  
NEW ALBANY

## LANDSCAPE ARCHITECT

MKSK

## STAKEHOLDERS + FOCUS GROUP MEMBERS

MAYOR  
SLOAN  
SPALDING

RON  
DAVIES

JAKE  
BAME

VICTOR  
WILSON

DENNIS  
KEESEE

SARAH  
HIGGISTON

TWP. ADMINISTRATOR  
BEN  
COLLINS

TOM  
RUBEY

KEN  
KREBS

RICH  
MCMUNN

PAUL  
HATFIELD

# WHERE WE'VE BEEN

“

The memorial should be a respectful tribute to honor our veterans by providing an enduring, special commemoration of their service that allows for reflection/contemplation in a quiet, natural setting.

Visitors should be able to sit, relax and reflect while at the memorial site. A natural setting is ideal where water and natural materials and components can be utilized to help emphasize and cultivate this experience.

QUOTE FROM THE VETERANS MEMORIAL VISIONING MEETING REPORT  
April 6, 2009



EXISTING VETERANS MEMORIAL

# 2 MAKING NEW ALBANY'S MEMORIAL

## OUR PROCESS

In order to create a unique Veterans Memorial for New Albany, the design team's process included:

- Benchmarks & Best Practices.  
The design team gathered benchmarks and reported best practices for the different types of applicable Veterans Memorials around the country and how those practices could be potentially applied to New Albany's Memorial.
- Focus Group.  
A group of New Albany residents, veterans, and, veterans' advocates were brought together to brainstorm intentions, ideas, and interests of the potential future memorial to assist with site location and program selection.
- Location & Program Assessment.  
Applying information from previous tasks, the group evaluated potential New Albany locations and specific programs applicable to those specific sites. This exercise also determined who and where the honorees will be recognized.
- Draft Concept Plans.  
The design team developed three different draft site concepts for the New Albany Veterans Memorial.
- Refinement of Singular Concept.  
The working group and design team focused on one hybrid approach to develop the final concept.

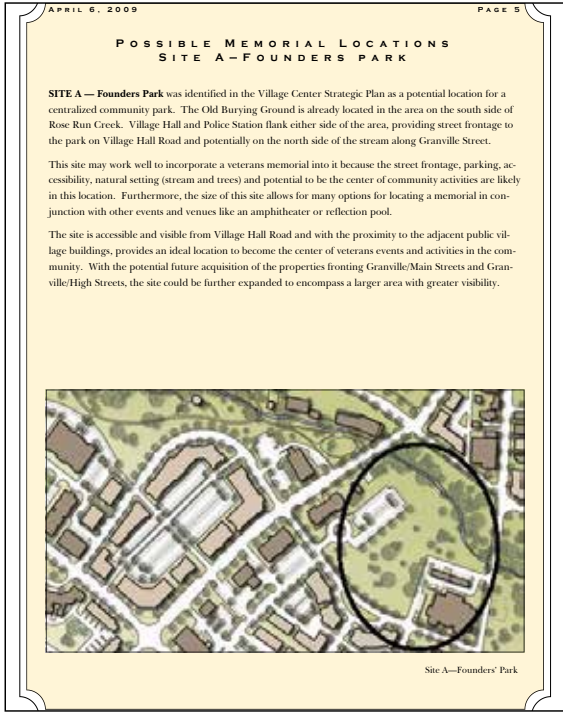

THE VETERANS MEMORIAL VISIONING MEETING REPORT  
April 6, 2009

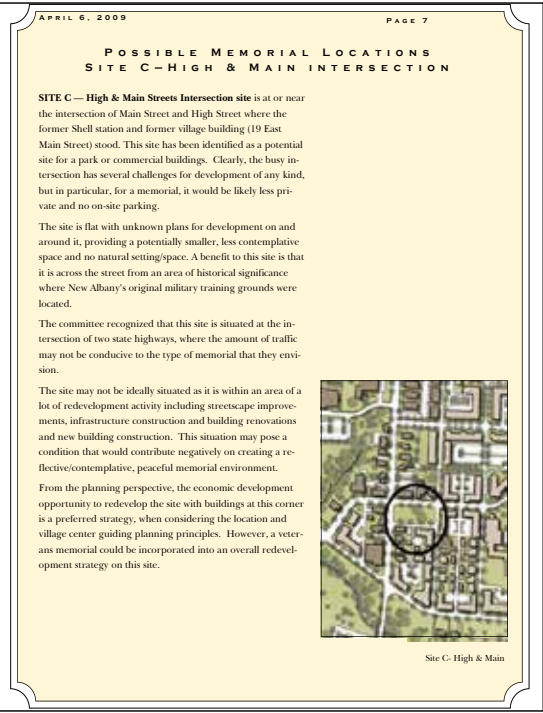
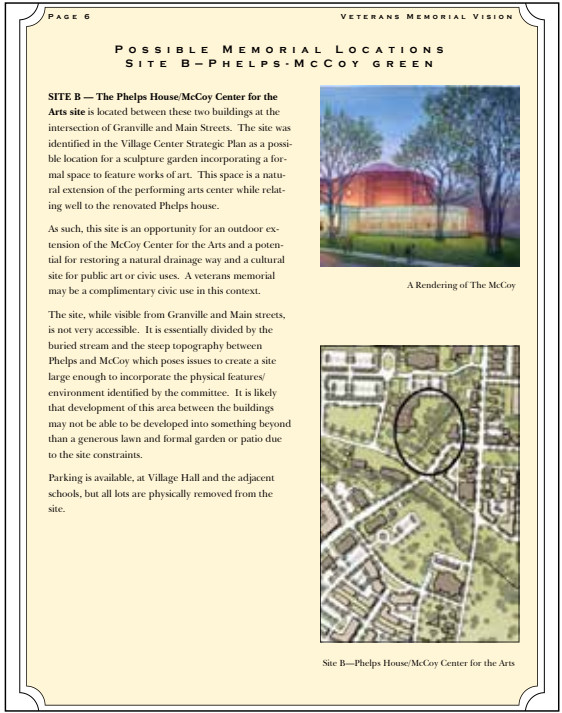



# FOCUS GROUP INPUT

- Acknowledge local and national veterans
- Acknowledge first responders
- Educate young people about service
- Honor the families that support veterans
- Provide space for contemplation
- Honor the physical and emotional toll carried by the individual veteran
- Reference the journey from Civilian, to Soldier, to veteran
- Connect to the greater history of New Albany



# PROJECT CONCEPT STATEMENT

## ***HONORING THE VETERANS SACRIFICE***

*We will elevate and honor veterans' and their families' sacrifices by telling the story of a serviceman's civilian life, their transformation into an active service member, the hardship of service, and, ultimately, the lasting impact of their service for their country, their families, and for themselves.*



# LOCATION + PROGRAM ASSESSMENT

## Where and what will this Memorial become?

A large part of this process was evaluating different ways memorials can be represented and how a memorial's location impacts its programming and use — essentially, tying site to program and program to site. This association not only creates strong and meaningful connections within the design, but it also helps to specifically inform how and where a memorial could or should be implemented within New Albany when existing and future contextual conditions are taken into account.



Memorial Park

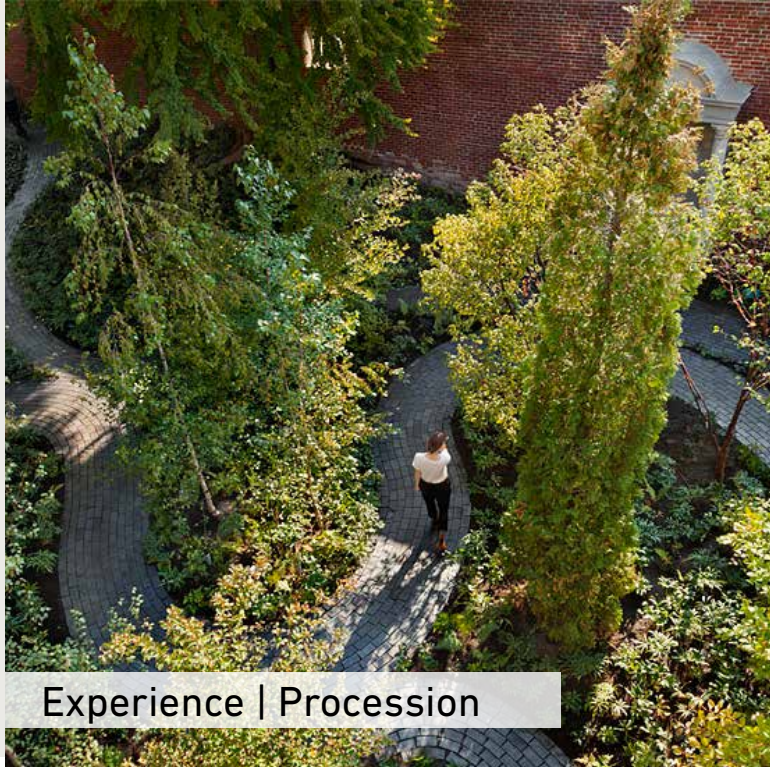

Experience | Procession



Interactive Object

# EXPLORING MEMORIAL TYPOLOGIES

## 1

### Interactive Object

- Object Within A Place
- Interactive Elements for Greater Activation
- Immediately Recognized
- Part Of Every Day Life
- Sculptural
- Celebratory
- Sensory

## 2

### Experience | Procession

- Contemplative Place
- Prescribed Path
- Emotional Connection
- Commemorative Names/Text
- Sense Of Honor and Formality
- Immersive
- Personal + Singular

## 3

### Memorial Park

- Community Amenity
- Reverent But Active
- Passive Program
- Commemorative Name
- Associated With Daily Life and Family Activity
- Could Include Pavilion or Structure With Names



# INTERACTIVE OBJECT



part of everyday life



object within a place



sensory



sculptural



immediately recognized

# EXPERIENCE | PROCESSION



contemplative place

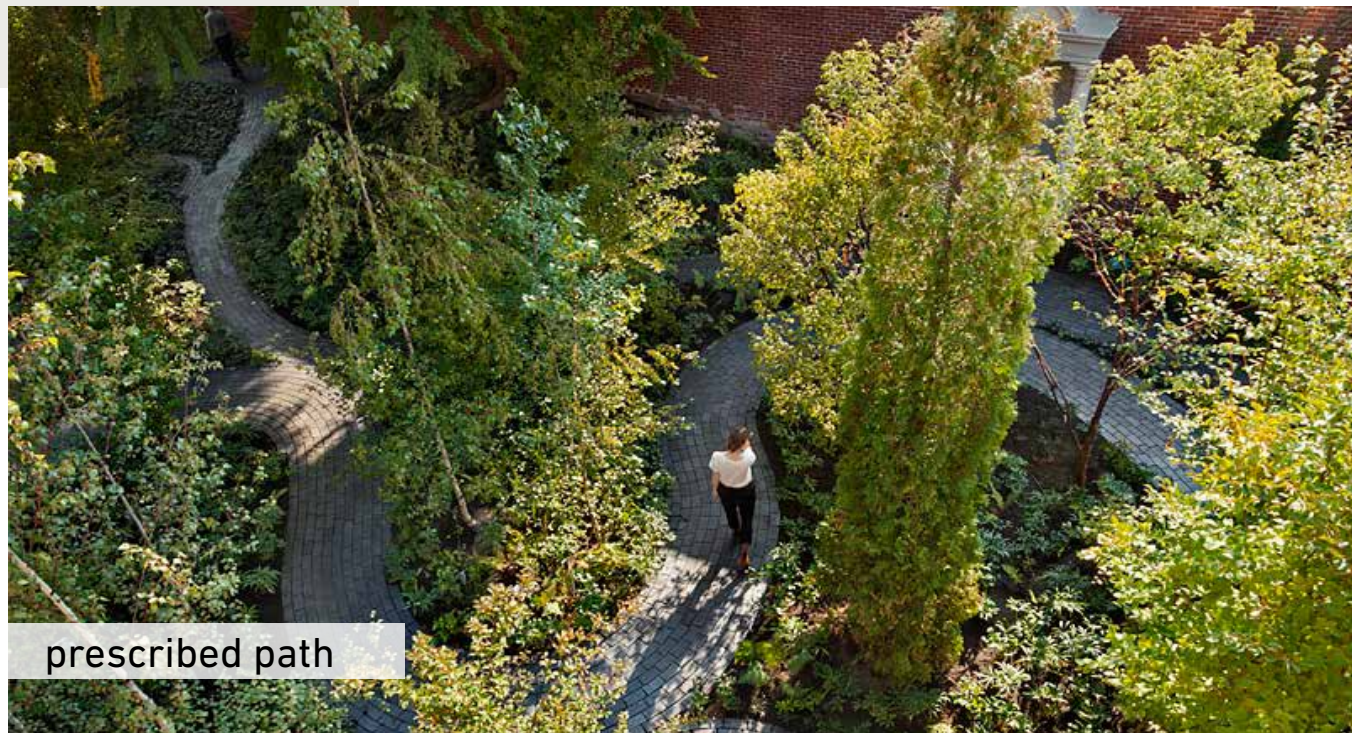

prescribed path



emotional connection



immersive



# MEMORIAL PARK



community amenity



daily life and family activity



passive program



pavilion or structure

# PROGRAM COMPARISONS



**ACTIVE | INTEGRATED**  
MOOD

**LOCAL PEDESTRIANS**  
TARGET USER

**SCULPTURAL | OBJECT**  
PROGRAM TYPE

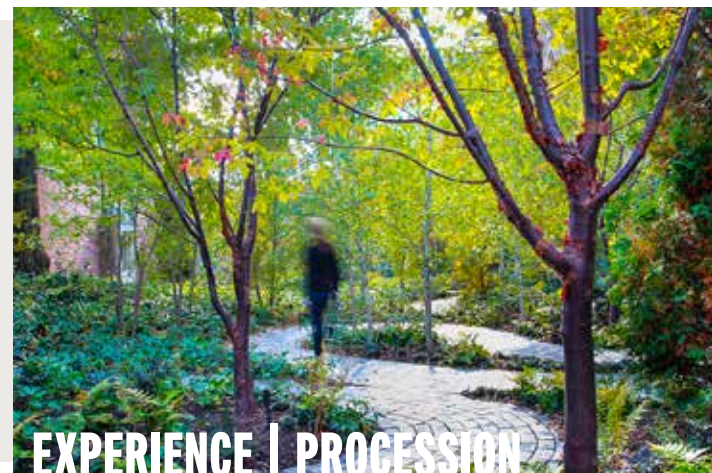

**CONTEMPLATIVE**  
MOOD

**INDIVIDUALS +  
SMALL GROUPS**  
TARGET USER

**SENSORY IMMERSION**  
PROGRAM TYPE



**COMMUNAL |  
CELEBRATORY**  
MOOD

**FAMILY +  
LEISURE**  
TARGET USER

**PARK | PAVILION**  
PROGRAM TYPE



# POTENTIAL SITE LOCATIONS

Multiple sites were evaluated throughout both the Village Center and the Historic Village Center — some previously studied in past reports as well as newly identified locations — all of which coordinate with different types of memorial programming and showcased how the memorial could be implemented within New Albany in different applications.

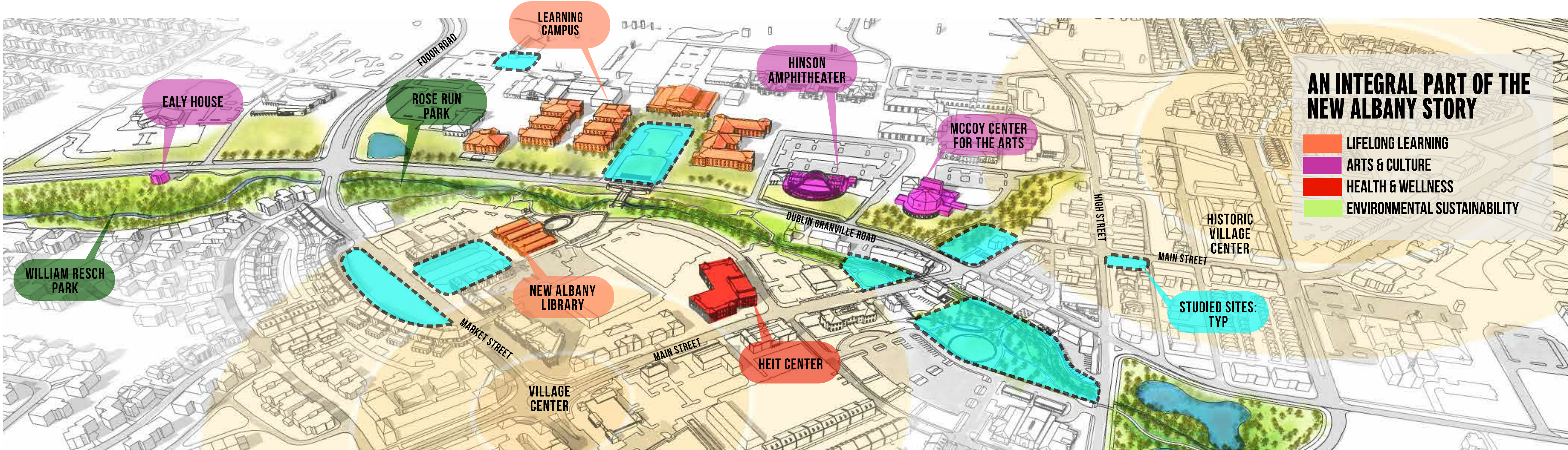



# SITE SELECTION(S)

Weighing site scale, location visibility, urban connectivity, and greenspace integration, the Working Group landed on two locations to support both the Veterans Memorial and the First Responders Pavilion – and, most importantly, their desired programs.

Veterans Memorial will be located within the currently planned Phase II of Rose Run Park and will incorporate the recently restored Founders Field. Located adjacent to City Hall and at the gateway of the new Rose Run II development, the site immediately feels part of the civic core and woven into the green necklace along Dublin Granville Road. Additionally, this location has access to ample parking and is well connected to existing pedestrian circulation.

First Responders Pavilion will occupy the northwest corner of Main Street and Dublin Granville Road (known locally known as the Phelps House Corner). The existing site faces challenges for traditional retail or office development; however, a park can be sustained and will add another stop along the green necklace. The new pavilion will give structure to the corner, completing this prominent New Albany intersection.

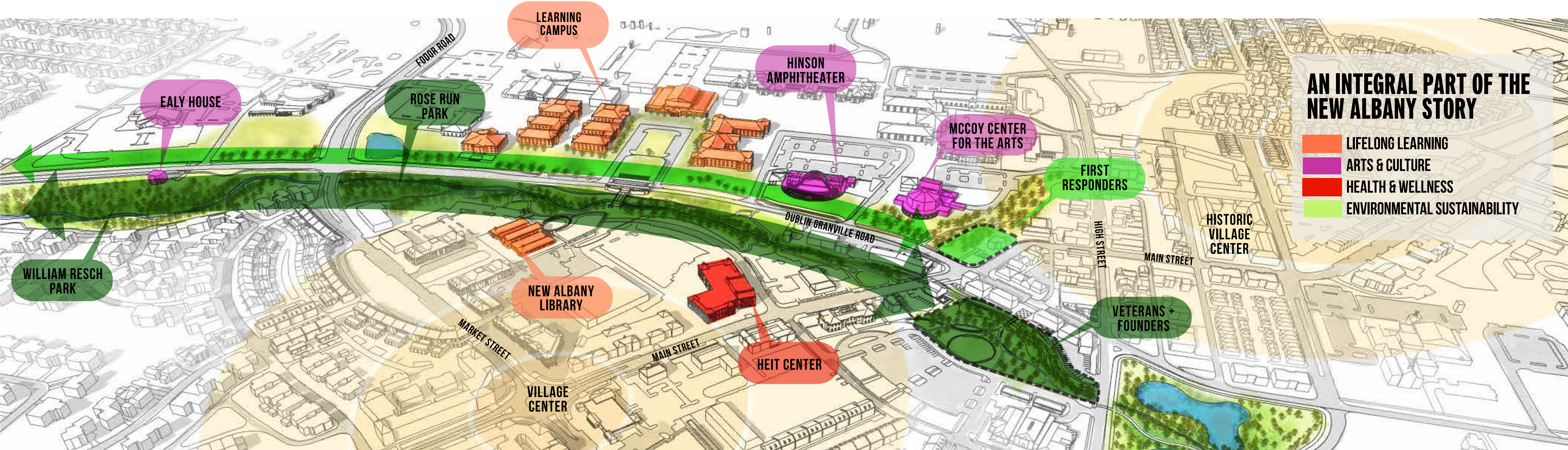



# ROSE RUN II + FOUNDERS FIELD EXISTING CONDITIONS



# ROSE RUN II + FOUNDERS FIELD EXISTING CONDITIONS

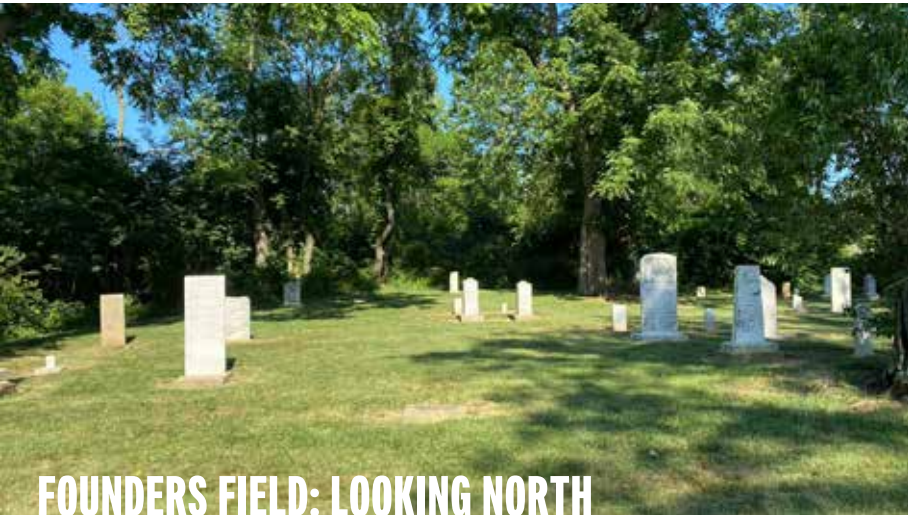



# ROSE RUN II REFRESHER 2018 EXTENDED GREENWAY PLAN



## LEGEND

THE VISION FOR ROSE RUN PHASE II CONSISTS OF THE FOLLOWING SIGNIFICANT COMPONENTS, WHICH ARE FURTHER DESCRIBED IN THE FOLLOWING PAGES.

- 1. FOUNDERS CEMETERY
- 2. MUNICIPAL PARKING LOT
- 3. COMMUNITY GARDENS
- 4. VILLAGE HALL DROP-OFF
- 5. THE GLEN
- 6. LOCUST SQUARE
- 7. STORMWATER PRESERVE
- 8. PHELPS HOUSE CORNER
- 9. ROSE RUN I TRAIL CONNECTION & MAIN STREET IMPROVEMENT AND INFILL

# ROSE RUN II REFRESHER 2018 EXTENDED GREENWAY PLAN

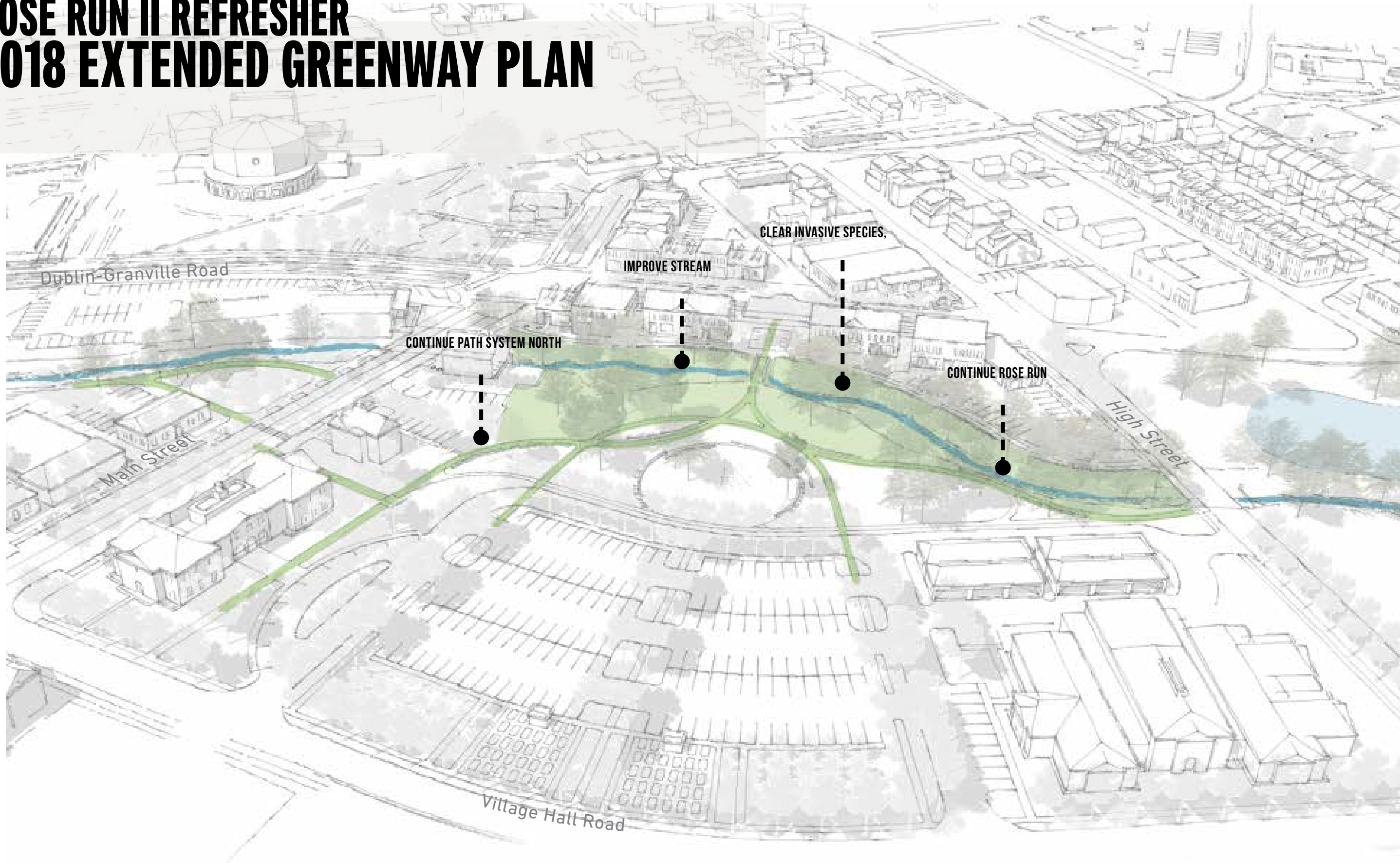



# THE CONCEPT

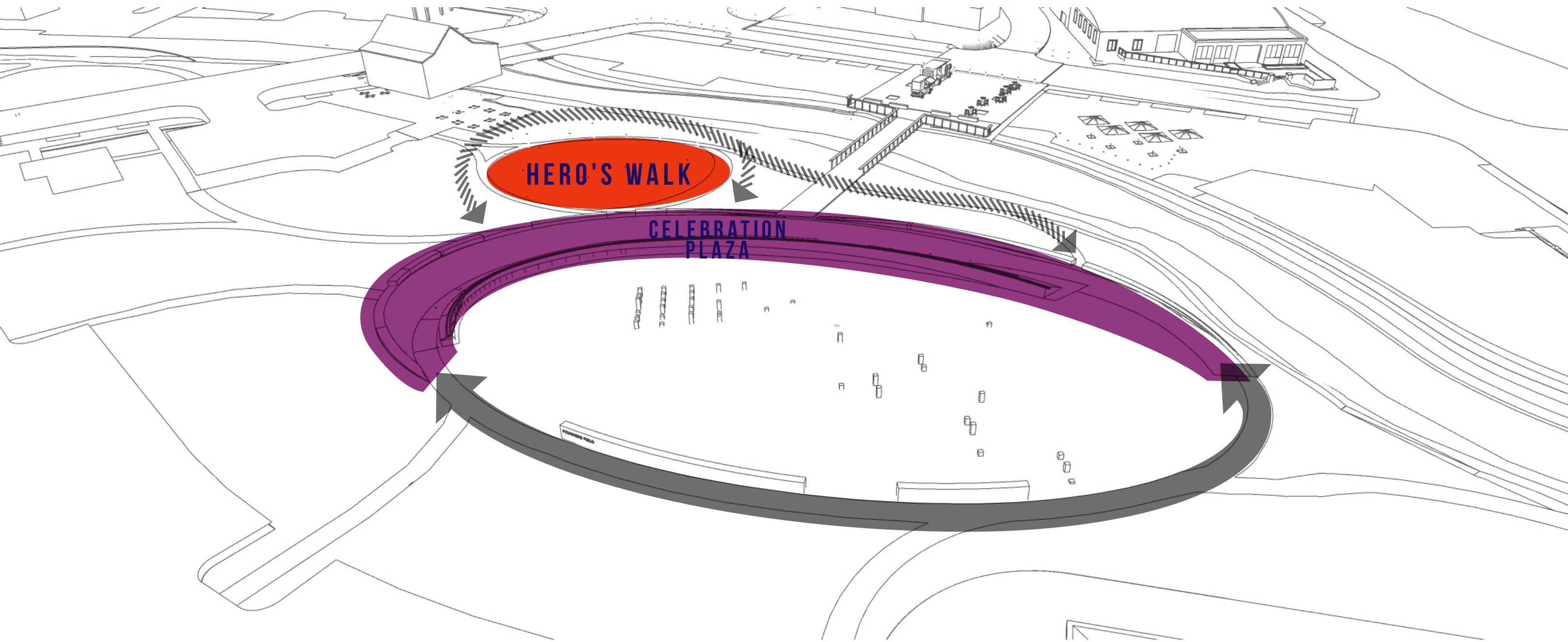

# NARRATIVE

## THE SERVICEMAN'S JOURNEY

A series of spaces that focus on the serviceman's journey from home to battle and back.

The **Celebration Plaza** acts as a prominent public space illustrating the serviceman's initial call to serve, tour of duty, and, ultimately, the return home. The space includes honorific text for each branch of service, the names of servicemen, and a special water feature.

The **Hero's Walk** sits adjacent to the Celebration Plaza and takes the visitor on an individual, contemplative walk through the nearby wood. Slender, elegant luminaries placed within the trees and around the path provide additional educational information and ephemeral interest when lit at night.



# NARRATIVE ELEMENTS

## WATER



## LIGHT

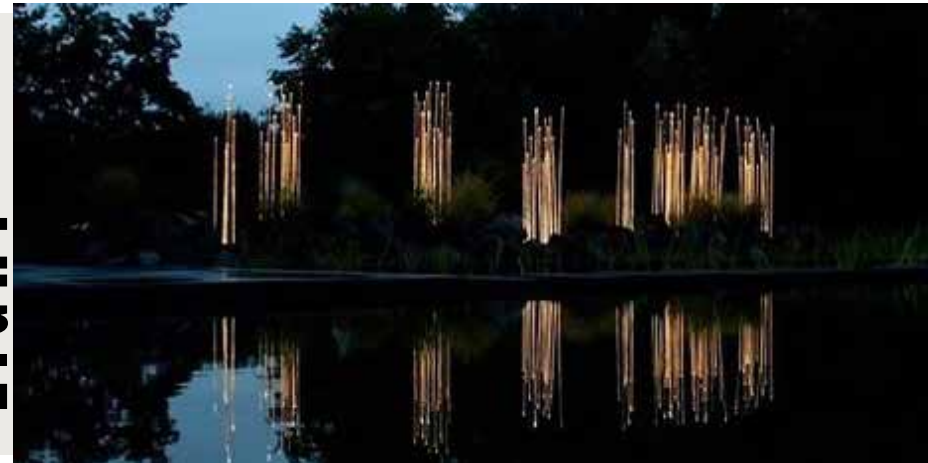

## PATH

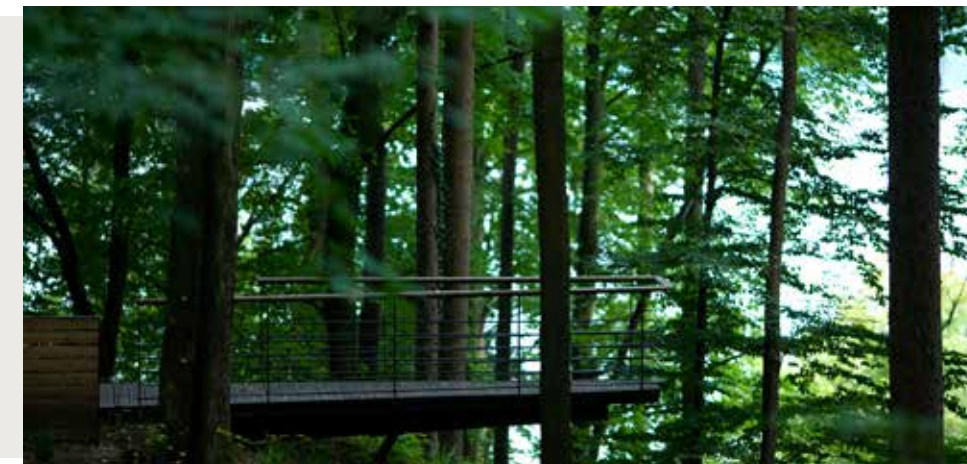

**MKSK**

november 2020

26

# INITIAL CONCEPT OPTIONS

## CONCEPT A: WATER



Sight lines from a new public plaza along Dublin Granville Road draw visitors across the Rose Run corridor and up to Celebration Plaza which includes a prominent sculptural wall for individual veteran recognition and a refined water feature for personal reflection. These features gently wrap Founders Field symbolizing the protection of the community allowing New Albany, and the nation, to flourish.

## CONCEPT B: LIGHT



A series of walls and sculptural light features radiate from Founders Field. These elements create a meditative experience as the visitor walks through the various pathways to learn about the sacrifice and service etched directly on the sculptural luminaries. These luminaires add an element of ephemeral beauty as they weave between trees in the existing woodland, evoking the sense of soldiers standing sentry on the battlefield.

## CONCEPT C: PATH



This dominant, yet delicate, path creates a unique journey where moments of memorial can occur. It acts as a physical narrative telling the story of the service man or woman of deployment, service, then eventual return home to celebrate after their tour of duty is complete. This processional experience takes visitors through the woodland, out to a stream overlook, and on into a sun soaked clearing where a pavilion provides space for gathering and commemorative events.

**MKSK**

november 2020

27



# HYBRID CONCEPT

After reviewing initial concepts, neither the Working Group nor the Focus Group showed preference towards one concept. Instead, **different elements from each** were selected to incorporate into a **hybrid concept** for the final iteration.

## CONCEPT A: FORM + WATER

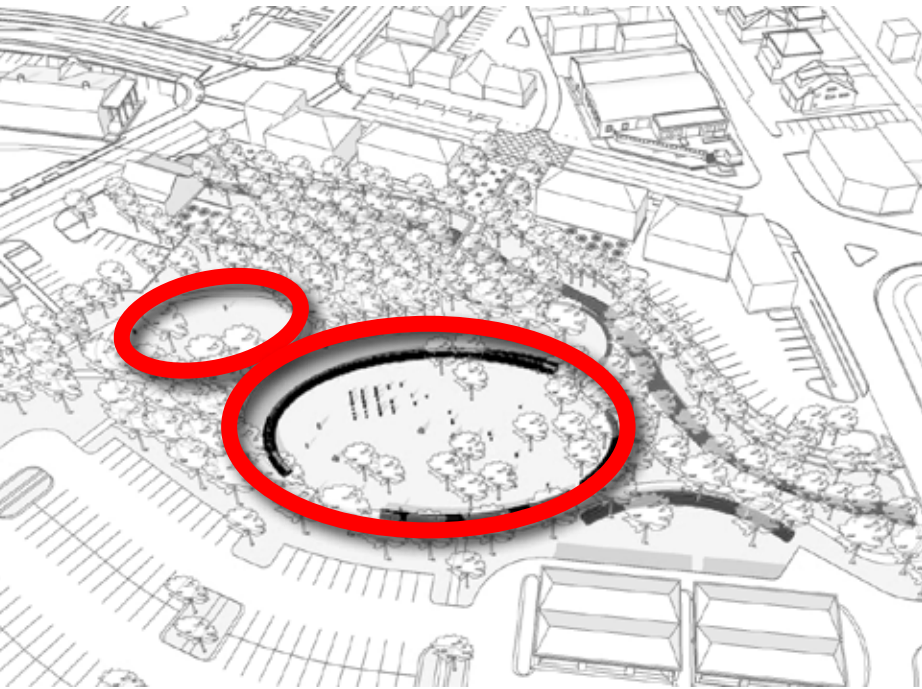

- Elements to incorporate:
- Form
  - Overall spacial concept
  - Incorporation of water
  - Feels prominent and important

## CONCEPT B: LUMINARIES

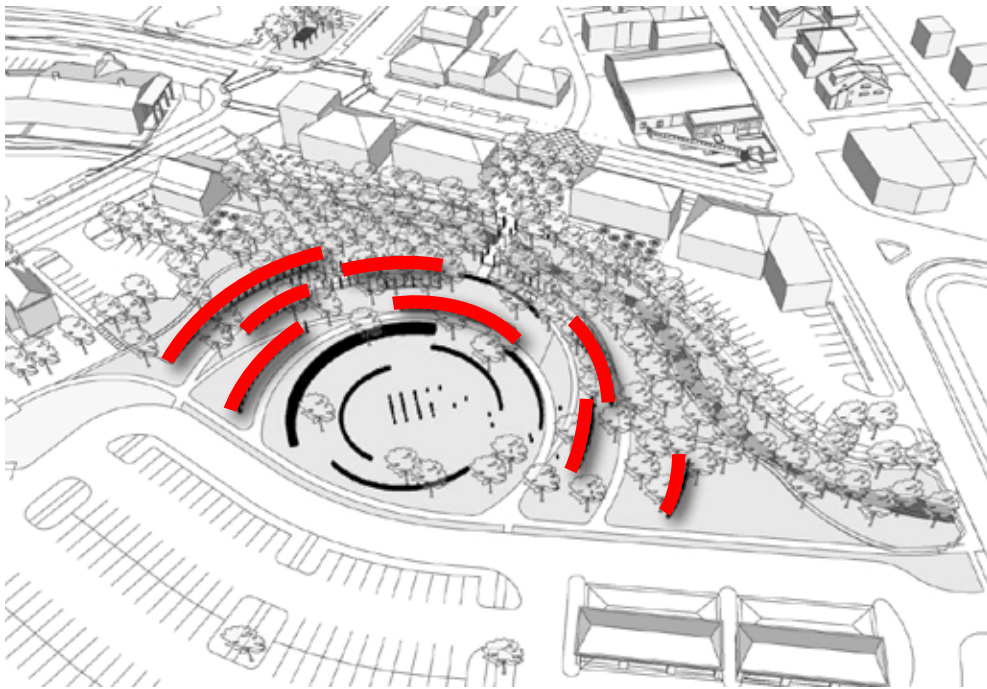

- Elements to incorporate:
- Narrative and representation of the sculptural luminaries

## CONCEPT C: CONTEMPLATIVE PATH

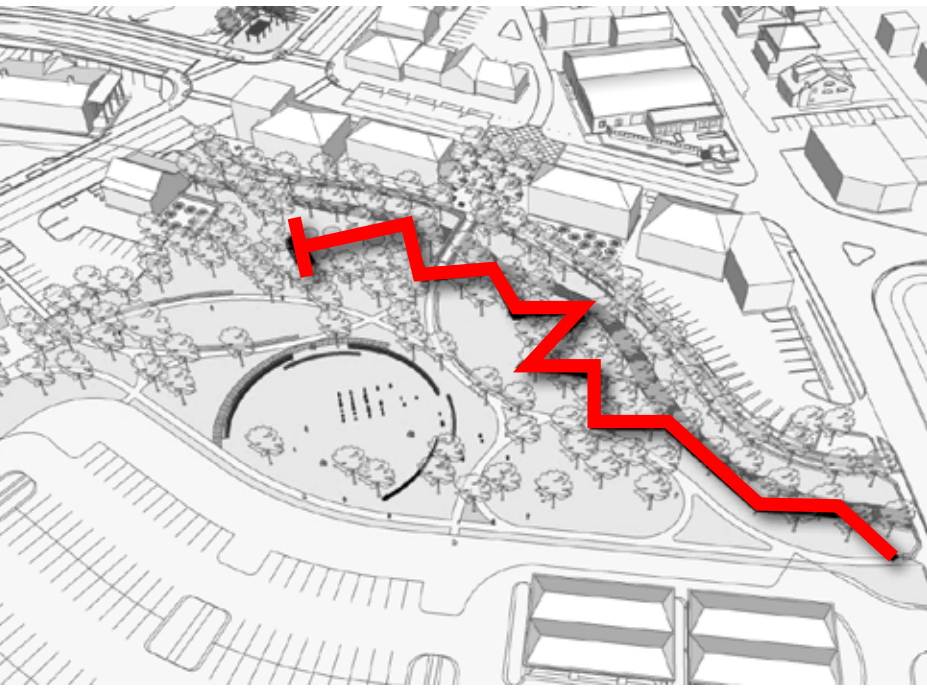

- Elements to incorporate:
- Processional walk as a physical narrative
  - Celebratory pavilion

# FINAL VETERANS MEMORIAL CONCEPT





# VETERANS MEMORIAL PROGRAM

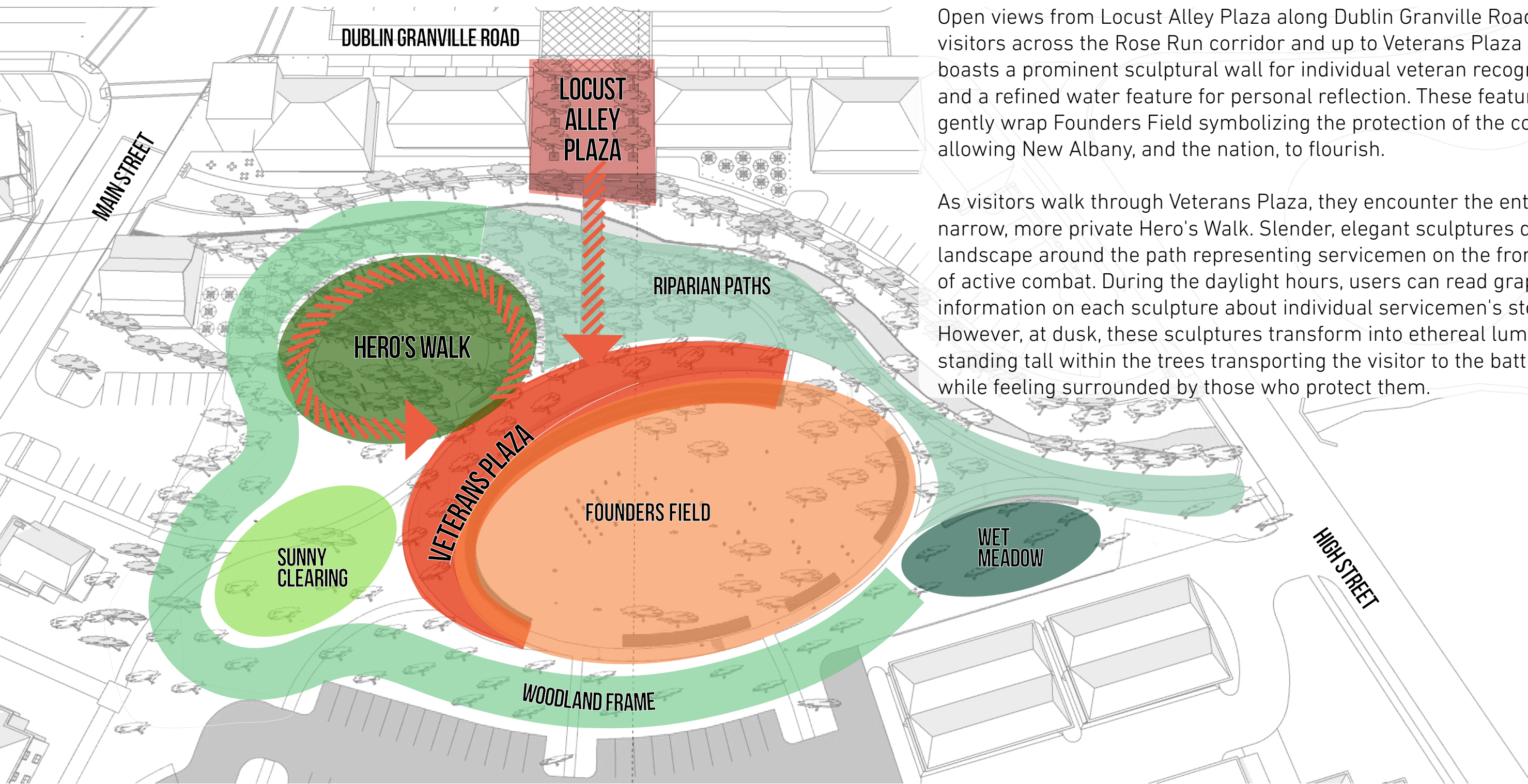

Open views from Locust Alley Plaza along Dublin Granville Road draw visitors across the Rose Run corridor and up to Veterans Plaza which boasts a prominent sculptural wall for individual veteran recognition and a refined water feature for personal reflection. These features gently wrap Founders Field symbolizing the protection of the community allowing New Albany, and the nation, to flourish.

As visitors walk through Veterans Plaza, they encounter the entry to the narrow, more private Hero's Walk. Slender, elegant sculptures dot the landscape around the path representing servicemen on the front lines of active combat. During the daylight hours, users can read graphic information on each sculpture about individual servicemen's stories. However, at dusk, these sculptures transform into ethereal luminaries standing tall within the trees transporting the visitor to the battlefield while feeling surrounded by those who protect them.

# FINAL VETERANS MEMORIAL CONCEPT: VIEW LOCATIONS

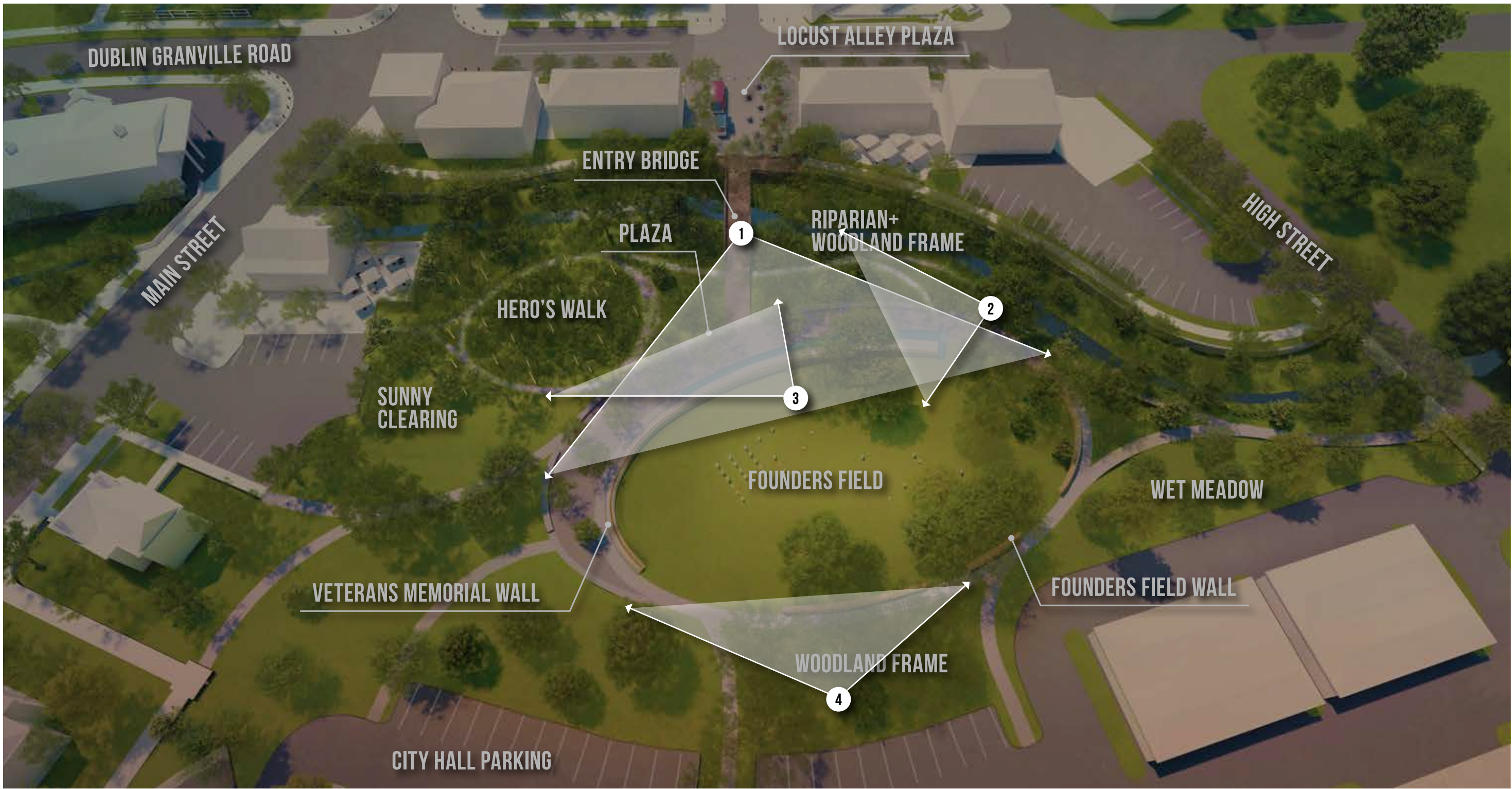



# VETERANS MEMORIAL: VIEW 1



# VETERANS MEMORIAL: VIEW 2





# VETERANS MEMORIAL: VIEW 3



# VETERANS MEMORIAL: VIEW 4





# FINAL FIRST RESPONDERS PAVILION CONCEPT



# FINAL FIRST RESPONDERS PAVILION CONCEPT: VIEW LOCATIONS





# FIRST RESPONDERS PAVILION: VIEW 1



# FIRST RESPONDERS PAVILION: VIEW 2





# VETERANS MEMORIAL ALTERNATE LAYOUT



# VETERANS MEMORIAL ALTERNATE LAYOUT: VIEW 2A





# FIRST RESPONDERS PAVILION ALTERNATE: VIEW 1A



# FIRST RESPONDERS PAVILION ALTERNATE: VIEW 2A





# 5 ORDER OF MAGNITUDE COSTS





